



# M-POWER-WLC-US-10-Qi-FS-BAB

## METRO 10W WIRELESS CHARGING UNIT

FREE STANDING 10W WIRELESS CHARGER SET FOR ANDROID AND IPHONE WIRELESS ENABLED CELL PHONES (Qi CERTIFIED)

Features:

|                            |                         |
|----------------------------|-------------------------|
| <b>Charger Dimensions:</b> |                         |
| <b>Length</b>              | 3.622" (92.000mm)       |
| <b>Width</b>               | 3.622" (92.000mm)       |
| <b>Height</b>              | 0.275" (7.000mm)        |
| <b>Adapter:</b>            |                         |
| <b>Input Voltage</b>       | 110-240 VAC (50-60 Hz.) |
| <b>Output Voltage</b>      | 5V/3A; 9V/2A; 12V/1.5A  |
| <b>Adapter Dimensions:</b> |                         |
| <b>Length</b>              | 2.696" (68.500mm)       |
| <b>Width</b>               | 1.889" (48.000mm)       |
| <b>Height</b>              | 1.086" (27.600mm)       |

- **Qi FAST CHARGING FREE-STANDING WIRELESS CHARGER**
- **OVERCURRENT PROTECTION AND SHORT-CIRCUIT PROTECTION**
- **INPUT: USB-QC2.0/3.0**
- **PRODUCT SUPPORT (TYP): SAMSUNG - 10W; IPHONE - 7.5W; Qi - 5W**
- **WPC Qi V1.2.4 CERTIFIED, COMPATIBLE WITH ALL Qi ENABLED DEVICES**

Bezel Finish: **BLACK (ABS)**  
*Custom Finishes Available* M-POWER-WLC-US-10-Qi-FS-BAB

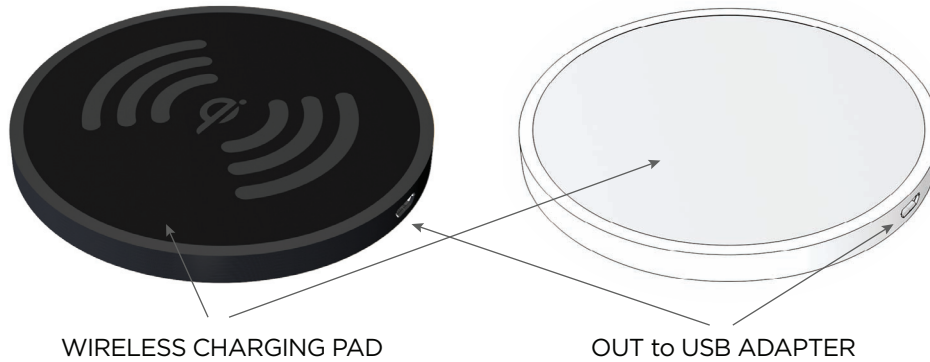

Shown in Black (ABS) Bezel.

WIRELESS CHARGING PAD

OUT to USB ADAPTER

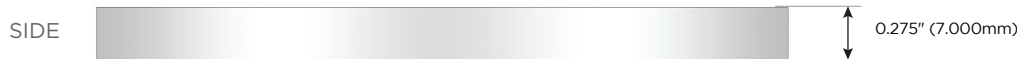

TOP

## M-POWER-WLC-US-10-Qi-FS-BAB

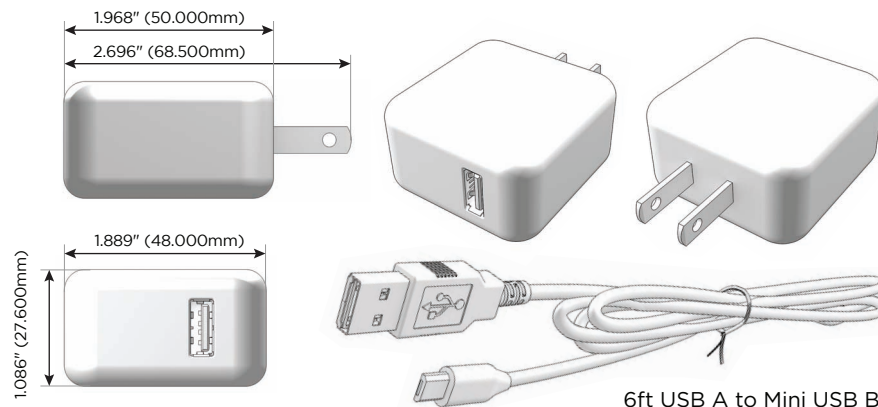

6ft USB A to Mini USB B Charging Cable included.

